

BATIMENT A

UNITE S2 N°A3.23

Niveau 03

SURFACES HABITABLES

Entrée	1.59m ²
SDE / WC	6.54m ²
Pièce de vie + pl. + kitch.	20.59m ²
Chambre + pl.	8.84m ²

Total habitable 37.56m²

Balcon 1.75m²

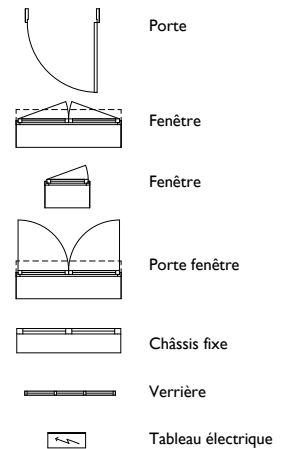
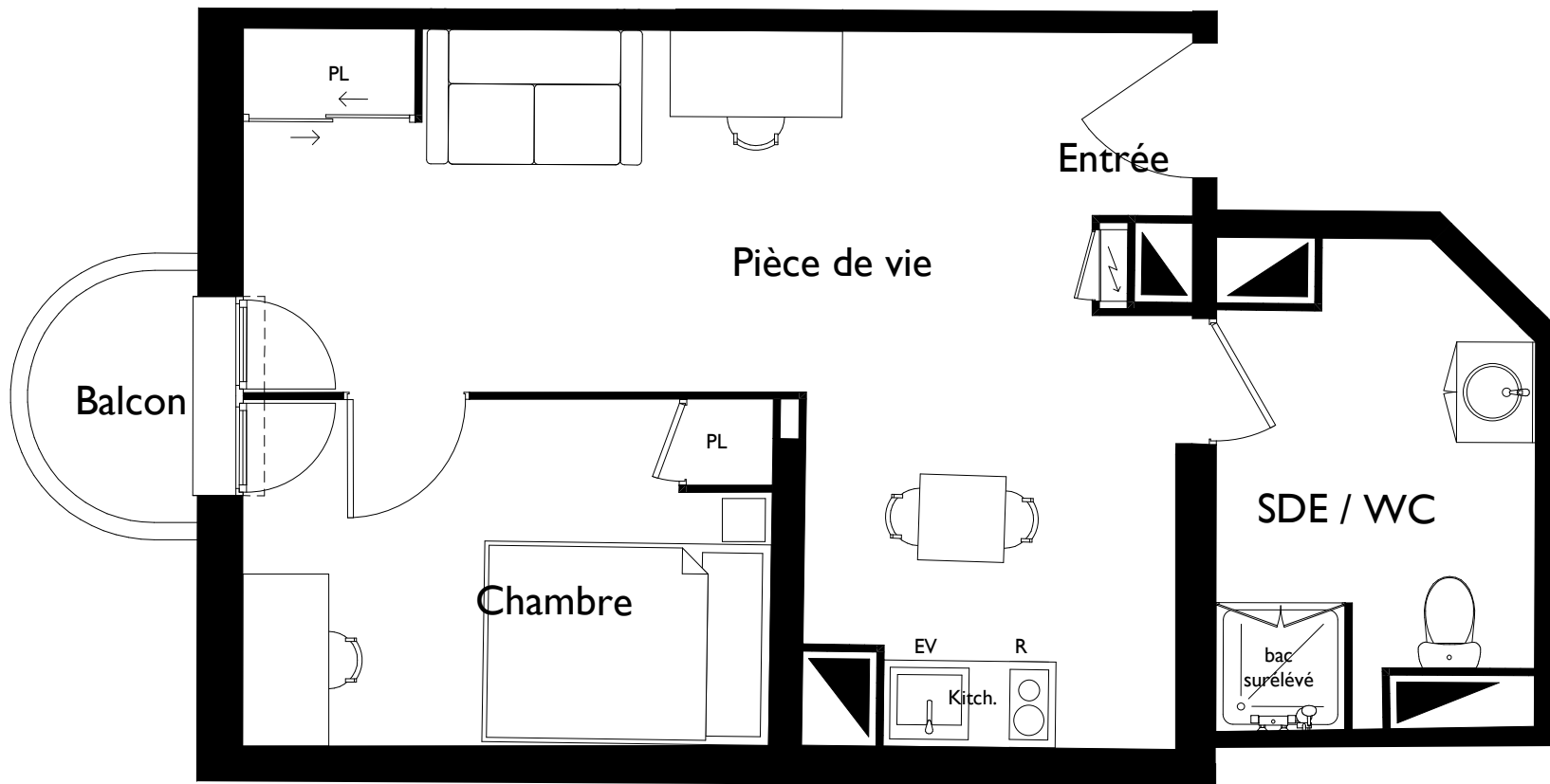

PL EV R

Placard Evier Réfrigérateur